

CUSTOMER APPROVAL	IF NOT RETURNED TO FGFT BY THE DATE INDICATED BELOW, WE WILL PROCEED WITH FABRICATION AS PER THE DRAWING
SALES SIGNATURE:	
CUSTOMER SIGNATURE:	
DATE:	
RETURN TO FGFT BY:	DATE: 23 JUNE 2023
REVIEWED BY:	
REVIEW DATE:	
ACCEPTED AS IS:	<input type="checkbox"/>
ACCEPTED WITH REVISION NOTED:	<input type="checkbox"/>
REVISE AS NOTED AND RE-SUBMIT:	<input type="checkbox"/>

BODY TYPE: EXTRUDED ALUMINUM  
TANK SIDE: DRY SIDE

DOC. NO. : E018-1 DRAWING TEMPLATE  
REV. C 2017-02-05

**SPECIFICATION**

**CHASSIS:**  
-FREIGHTLINER M2 112 SBA REGULAR CAB  
-47000 LB GVWR; 16000 LB FRONT / 31,000 LB REAR  
-DIESEL ENGINE, CUMMINS L9 450 EV HP  
-AUTOMATIC TRANSMISSION, ALLISON 3000 EVS  
-ELECTRONIC STABILITY CONTROL BY CHASSIS

**PUMP:**  
-HALE MIDSHIP QMAX 1500  
-1500 USGPM (5678 LPM) (1250 IGPM) AT 150 PSI  
-THIRD PARTY CERTIFICATION MEETING NFPA 1901-2016

**PLUMBING:**  
-2 x 6" SUCTION, (1)ROAD (1)CURB  
-1 x 2 1/2" GATED SUCTION, (1)ROAD  
-3 x 2 1/2" DISCHARGE PORT, (2)ROAD (1)CURB  
-1 x 2 1/2" CROSSLAY  
-1 x 3" MONITOR STAND PIPE  
-1 x 1 1/2" CROSSLAY  
-1 x 5" STORZ DISCHARGE W/3" PLUMBING, (1)CURB  
-1 x 4" STORZ EXTERNAL TANK FILL FIREMAN'S FRIEND W/5" ADAPTER  
-4" TANK TO PUMP, W/3" BUTTERFLY VALVE  
-2" TANK FILL AKRON

**TANK:**  
-2040 USG (1700 IG) WATER TANK

**BODY:**  
-PUMPER TANKER, EXTRUDED ALUMINUM LOW/LOW  
-BODY UNDERCOATING CORASHIELD

**EMERGENCY EQUIPMENT/ACCESSORIES:**  
- LIGHT BAR 60" LED  
- SIREN SMART

**MODEL:**  
WHELEN FREEDOM IV 60"  
WHELEN CEN COM  
SAPPHIRE W/MIC  
WHELEN SA315P  
WHELEN L31HRFN LED  
WHELEN M6 LED  
WHELEN M6 LED  
WHELEN M6 LED  
WHELEN M9LZC LED  
LUMA BAR H20-12"  
AIRINLET  
KUSSMAUL AUTO  
CHIEF SERIES SMART  
CHARGER 40 AMP

- 1 x 100W SPEAKER  
- 2 x REAR BEACONS RED/BLUE  
- 2 x GRILLE LIGHTS RED  
- 6 x SIDE LOWER WARNING LIGHTS RED  
- 2 x REAR LOWER WARNING LIGHTS RED/BLUE  
- 6 x SCENE LIGHTS  
- 6 x GROUND LIGHTS  
- AIR CHARGING PROVISION  
- BATTERY CHARGING PROVISION  
- 2 x ANTENNA MOUNT

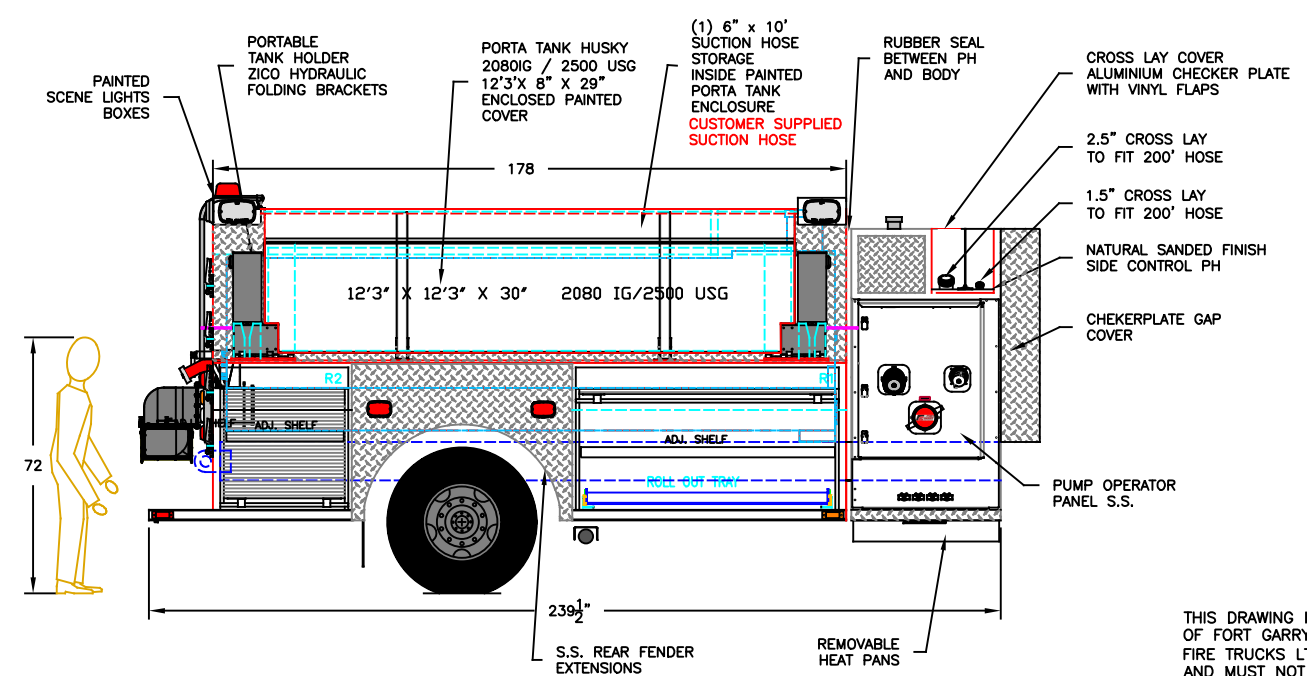
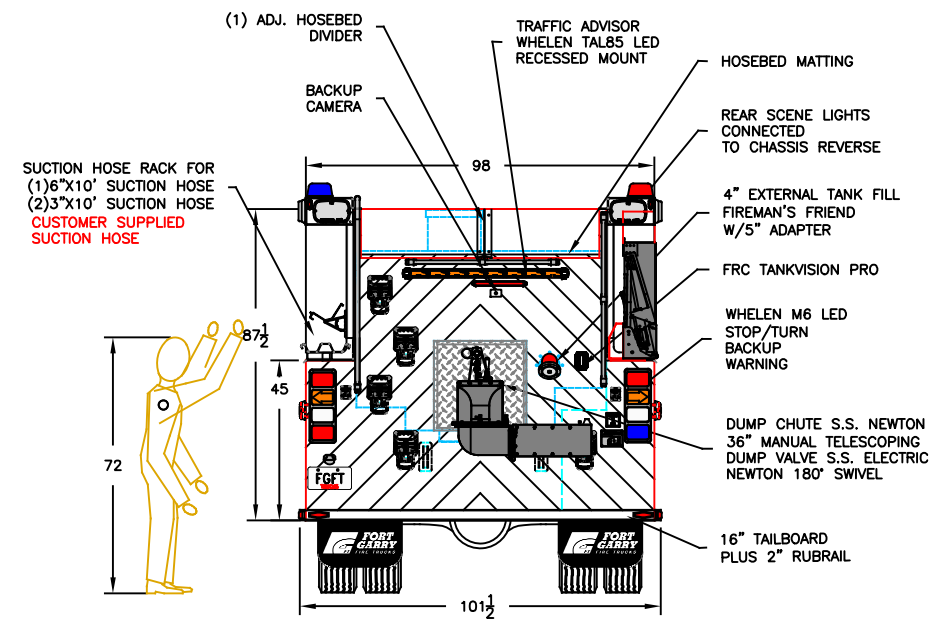
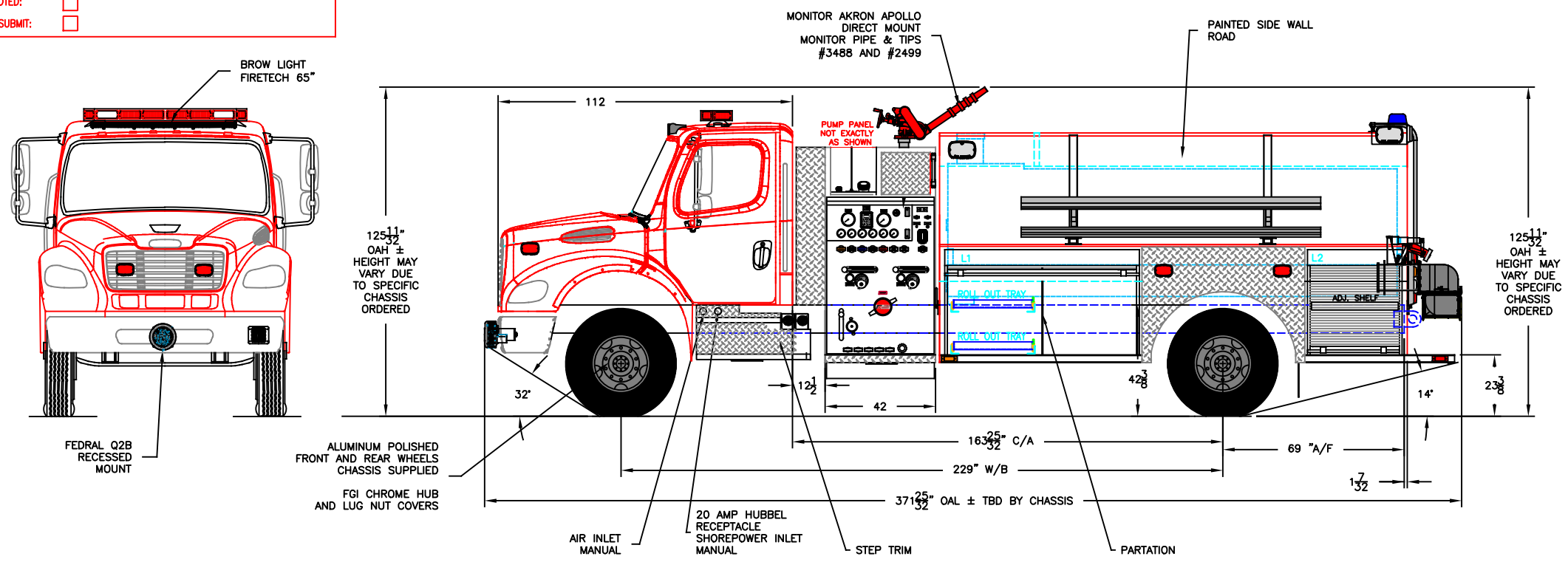

THIS DRAWING IS PROPERTY OF FORT GARRY FIRE TRUCKS LTD (FGFT) AND MUST NOT BE COPIED OR REPRODUCED IN WHOLE OR IN PART, BY ANY METHOD WHATSOEVER, WITHOUT AUTHORIZATION OF FGFT.

COMPT.	COMPARTMENT FRAME DIMENSIONS
L1	74W x 40H x 13.5/26D
L2	36W x 40H x 13.5/26D
R1	74W x 40H x 13.5/26D
R2	36W x 40H x 13.5/26D

- NOTES:**
- THE DRAWING IS FOR REFERENCE PURPOSE, ONLY. THE DRAWING MAY OR MAY NOT SHOW ALL ITEMS AS DESCRIBED IN THE WRITTEN DETAILED SPECIFICATION.
  - INCLUSION OF AN ITEM ON THE DRAWING DOES NOT CONSTITUTE INCLUSION OF THAT ITEM WITH THE FINAL DELIVERY OF THE UNIT. SPECIFICATION SHALL BE FINAL AUTHORITY TO BE DETERMINED WHAT IS SUPPLIED ON THE APPARATUS.
  - THE EFFECTIVE DOOR OPENING FOR ROLLUP DOORS WILL BE REDUCED APPROX. 10" IN HEIGHT, 2" IN DEPTH AND 2" IN WIDTH FROM SHOWN FRAME OPENINGS AND 2" IN HEIGHT, 3" IN DEPTH AND UP TO 4" IN WIDTH FOR PAN DOORS. DIMENSIONS TOLERANCE ± 1/4"
  - PUMP RATING AND TANK CAPACITY ARE SHOWN AS NOMINAL VALUES. THE ACTUAL VALUES MAY VARY.
  - CHASSIS GVWR SHOWN IS THE MINIMUM REQUIRED FOR STANDARD BODY DEPENDING OF OPTIONS, GVWR MAY NEED TO BE INCREASED.
  - COMMERCIAL OEM CAB STEPS MAY NOT MEET ULG STANDARD. SELECT CUSTOM STEPS WHEN REQUIRED
  - OVERALL HEIGHT IS IN LOADED CONDITION, UNLOADED HEIGHT MAY BE 4" ABOVE HEIGHT SHOWN. AFTER TRUCK IS COMPLETED ADDITIONAL STEPS MAY BE REQUIRED TO MEET THE STANDARD.
  - DIMENSIONS SHOWN ARE APPROXIMATE AND ARE SUBJECT TO CHANGE AS MAY BE FOUND NECESSARY DURING DESIGN. DO NOT SCALE DRAWING.
  - MINOR DETAILS AND REFLECTIVE STRIPING ARE NOT SHOWN.

B	CUSTOMER SIGN OFF DRAWING	SP	05 JUNE 2023
A	CRM DRAWING	SP	20 MAR 2023
REV	DESCRIPTION OF CHANGE	BY	DATE

**FORT GARRY**  
FIRE TRUCKS  
WWW.FGFT.COM  
WINNIPEG, MANITOBA, CANADA 1-800-565-3473

DESCRIPTION:	SIDNEY NY F.D.		
SCALE:	1:50	DWG. BY:	TV
		CHK. BY:	

MODEL:	APTS17H6	SHEET:	1 OF 1
DATE:	23 FEB 2022	DWG. NO. :	J0384